

DOCUMENT HOLDER

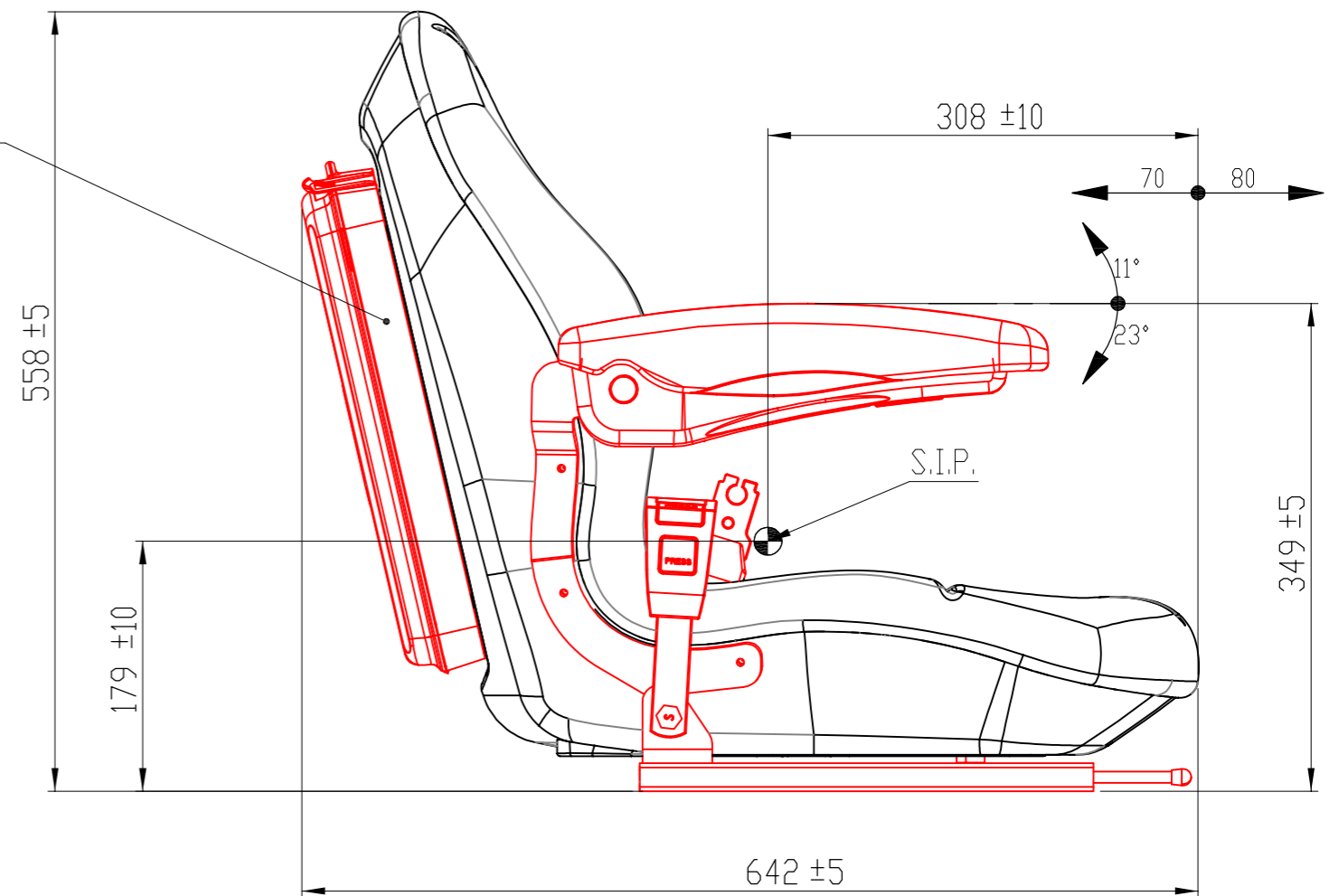

PRE-TRATTAMENTO SUPERF. (1st SURF. TREATMENT)		TRATTAMENTO SUPERF. FINALE (LAST SURF. TREAT.)		QUANTITA' (Q.TY)	RUGOSITA' SUPERF. (SURF. ROUGHN.)
TRATT. TERMICO (HEAT TREATMENT)		PESO GREZZO (RAW W.) (Kg)	PESO FINITO (FINAL W.) (Kg)	FOGLIO (SHEET)	✓ [1.6 / 3.2 / 6.3]
TOLLERANZE GENERALI CARP. (GENERIC CARPENTRY TOLERANCES) :					SMUSSI NON QUOT : 1X45° - RAGGI : R0,5 (CHAMFERS WITHOUT TOL : 1 X 45° - FILLETS : R0,5)
CESOIA (SHEARING), PIEGA (BENDING) E OSSITAGLIO (DXYCUTTING) : ± 1 mm - SALDATURA (WELDING) : ± 2 mm - PIEGATURA (BENDING) : ± 1°					
DIM. LIN. E ANG. (LIN. & ANG. DIM.)	F	FINE	H	GRADO DI PREC. PER QUOTE LINEARI E ANGOLARI SENZA TOLLERANZA SECONDO UNI-EN 22768-1 (PREC. LEVEL FOR LINEAR AND ANGULAR DIMENSIONS WITHOUT TOL. ACCORDING UNI-EN 22768-1)	A3
	M	MEDIA (MEDIUM)	K		
	C	GROSSOLANA (COARSE)	L	GRADO DI PREC. PER TOLLERANZE GEOMETRICHE GENERALI SECONDO UNI-EN 22768-2 (PREC. LEVEL FOR GENERIC GEOMETRIC TOL. ACCORDING UNI-EN 22768-2)	
	V	MOLTO GROSSOLANA (VERY COARSE)	-		
DISEGNATO (DRAWN) : Malaguti		MATERIALE (MATERIAL) :			
CONTROLATO (CHKD) : Malaguti		DESCRIZIONE (DESCRIPTION) : SEAT 21 INCH + MICROSWITCH + ADJUSTABLE ARMRESTS + DOCUMENT HOLDER + BLACK SKY			
CAMPAGNOLA (RE) - ITALY		COD. ATZ. (TOOL REF.) : --		CODICE (REF.) :	
DATA (DATE) 21/03/2022		SCALA (SCALE) 1:5		INC21N001602056	

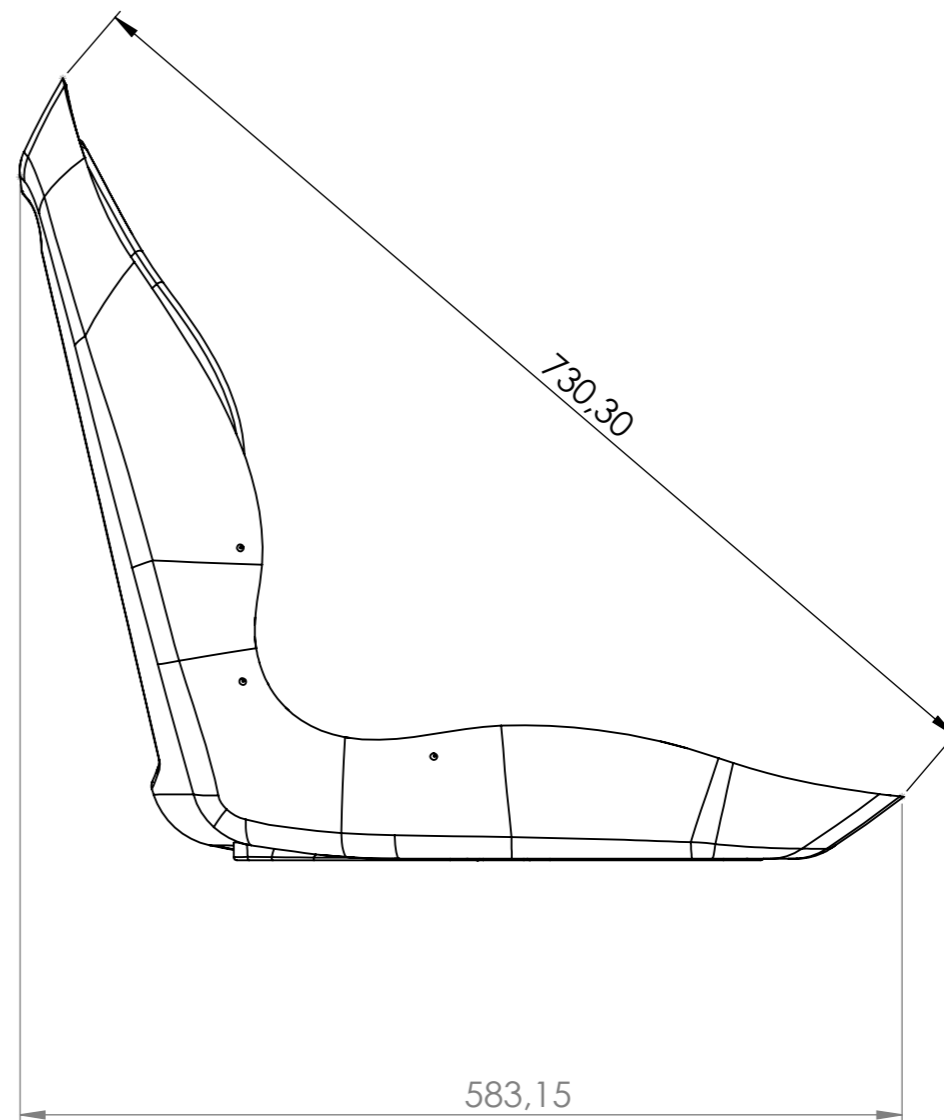
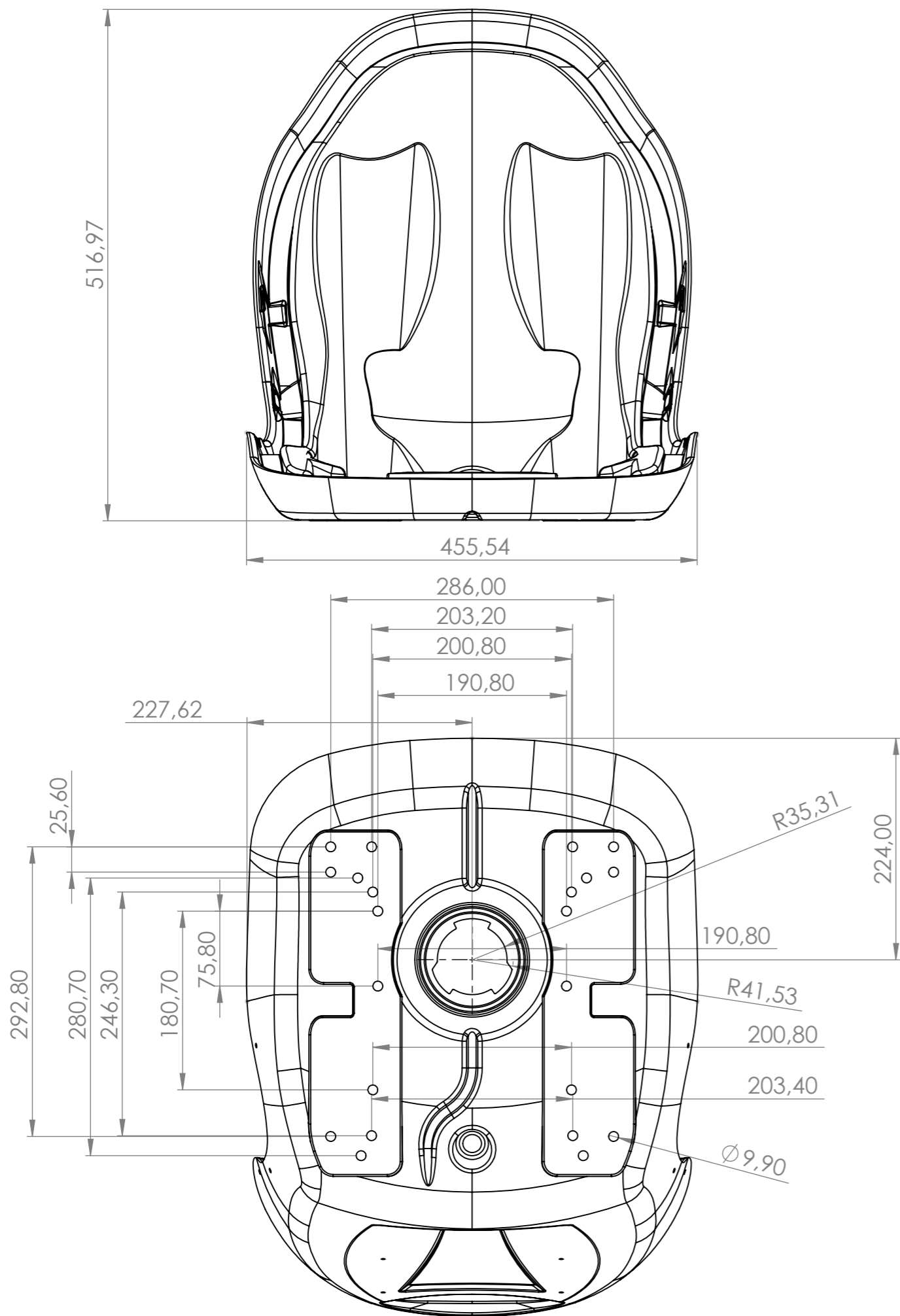

PRE-TRATTAMENTO SUPERF. (1st SURF. TREATMENT)		TRATTAMENTO SUPERF. FINALE (LAST SURF. TREAT.)		QUANTITA' (Q.TY)	RUGOSITA' SUPERF. (SURF. ROUGHN.)
TRATT. TERMICO (HEAT TREATMENT)		PESO GREZZO (RAW W.) (Kg.)	PESO FINITO (FINAL W.) (Kg)	FOGLIO (SHEET)	✓ [1.6 / 3.2 / 6.3]
TOLLERANZE GENERALI CARP. (GENERIC CARPENTRY TOLERANCES) :				SMUSSI NON QUOT : 1X45° - RAGGI : R0,5 (CHAMFERS WITHOUT TOL : 1 X 45° - FILLETS : R0,5)	
CESOIA (SHEARING), PIEGA (BENDING) E OSSITAGLIO (OXYCUTTING) : ± 1 mm - SALDATURA (WELDING) : ± 2 mm - PIEGATURA (BENDING) : ± 1°					
DIM LINE ANG (LIN. & ANG. DIM.)	F	FINE	H	GRADO DI PREC. PER QUOTE LINEARI E ANGOLARI SENZA TOLLERANZA SECONDO UNI-EN 22768-1 (PREC. LEVEL FOR LINEAR AND ANGULAR DIMENSIONS WITHOUT TOL. ACCORDING UNI-EN 22768-1)	
	M	MEDIA (MEDIUM)	K		
	C	GROSSOLANA (COARSE)	L	GRADO DI PREC. PER TOLLERANZE GEOMETRICHE GENERALI SECONDO UNI-EN 22768-2 (PREC. LEVEL FOR GENERIC GEOMETRIC TOL. ACCORDING UNI-EN 22768-2)	
	V	MOLTO GROSSOLANA (VERY COARSE)	-		
DISEGNATO (DRAWN) : Malaguti		MATERIALE (MATERIAL) :			
CONTROLATO (CHKD) : Malaguti		DESCRIZIONE (DESCRIPTION) :			
 CAMPAGNOLA (RE) - ITALY		Scocca con connettore micro posteriore			
		COD. ATRZ. (TOOL REF.) : --		CODICE (REF.) :	
DATA (DATE) 14/06/2021		SCALA (SCALE) 1:5		 PLA522-22P	

A3

8 7 6 5 4 3 2 1

F
E
D
C
B
A

F
E
D
C
B
A

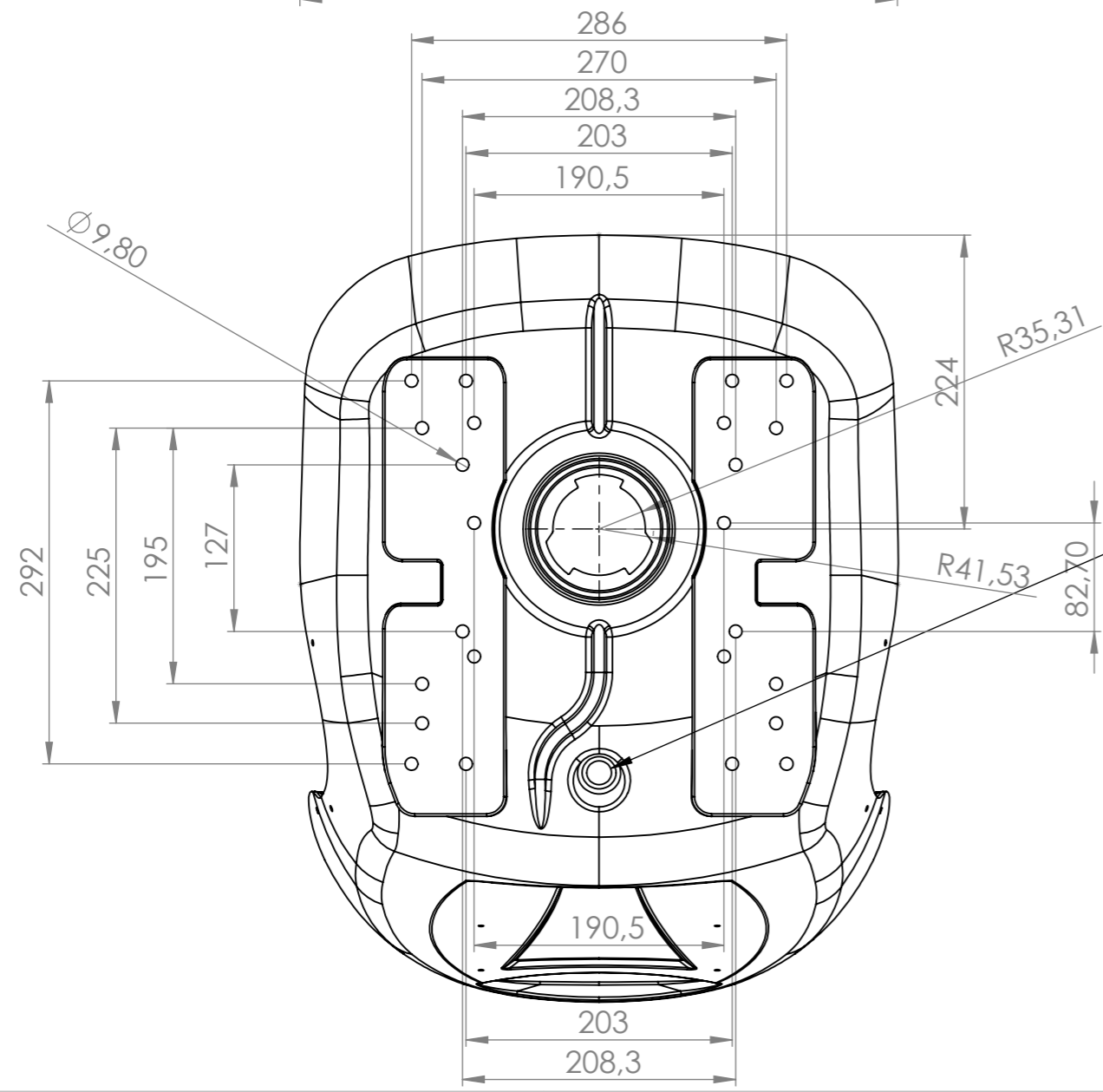
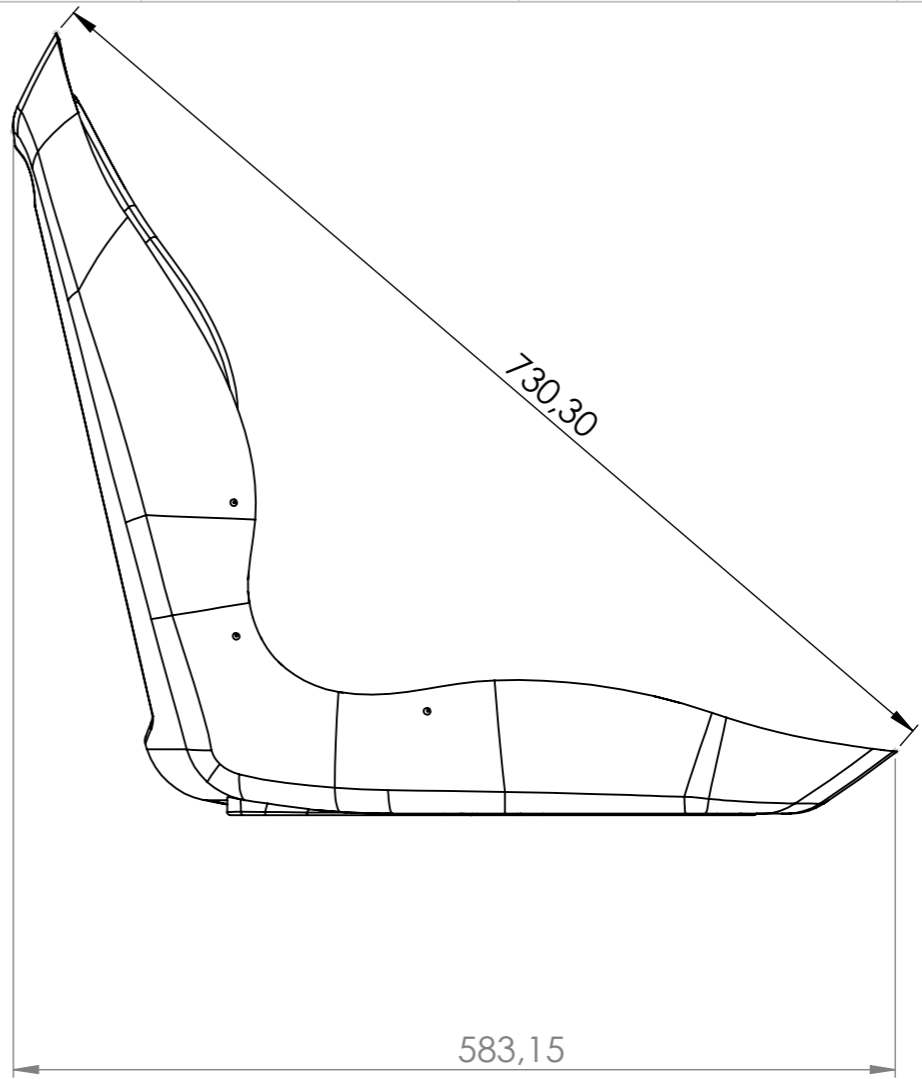
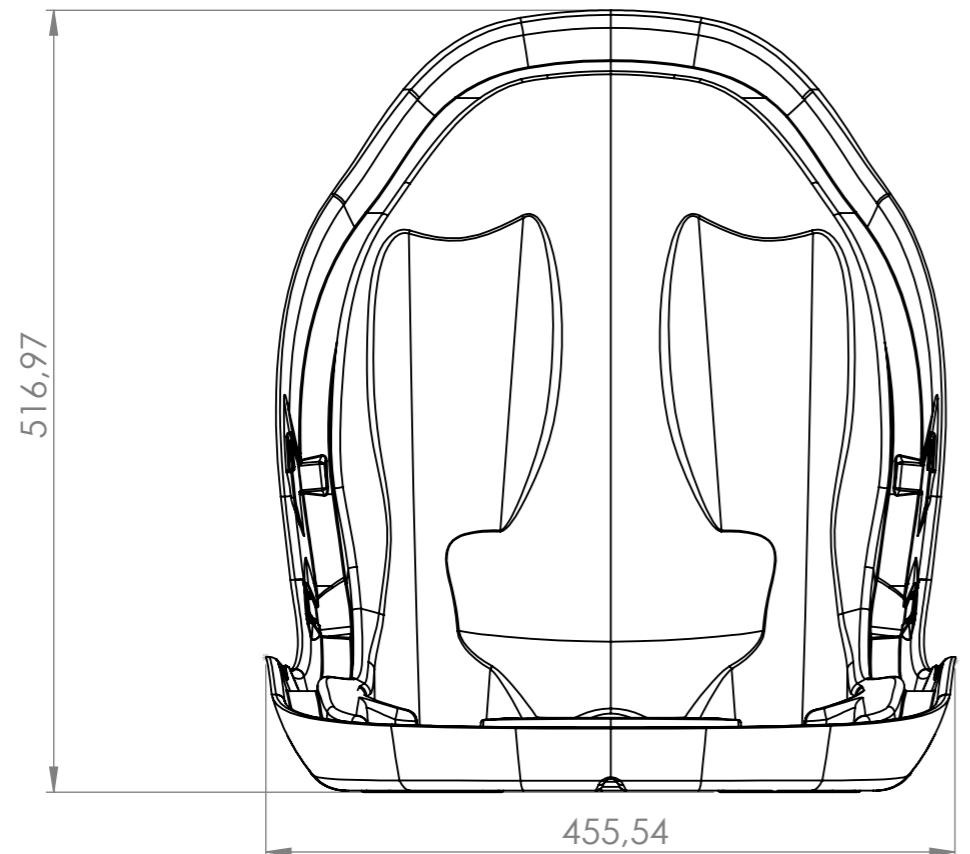

IL FORO DI SCOLO DEVE ESSERE $\varnothing 19$
(NON SBAVARE)

PRE-TRATTAMENTO SUPERF. (1st SURF. TREATMENT)		TRATTAMENTO SUPERF. FINALE (LAST SURF. TREAT.)		QUANTITA' (Q.TY)	RUGOSITA' SUPERF. (SURF. ROUGHN.)
TRATT. TERMICO (HEAT TREATMENT)		PESO GREZZO (RAW W.) (Kg.)	PESO FINITO (FINAL W.) (Kg)	FOGLIO (SHEET)	<input checked="" type="checkbox"/> [1.6 / 3.2 / 6.3]
TOLLERANZE GENERALI CARP. (GENERIC CARPENTRY TOLERANCES) :				SMUSSI NON QUOT : 1X45° - RAGGI : R0,5 (CHAMFERS WITHOUT TOL : 1 X 45° - FILLETS : R0,5)	
CESOIA (SHEARING), PIEGA (BENDING) E OSSITAGLIO (OXYCUTTING) : ± 1 mm - SALDATURA (WELDING) : ± 2 mm - PIEGATURA (BENDING) : $\pm 1^\circ$					
DIM LINE ANG (LIN. & ANG. DIM.)	F	FINE	H	GRADO DI PREC. PER QUOTE LINEARI E ANGOLARI SENZA TOLLERANZA SECONDO UNI-EN 22768-1 (PREC. LEVEL FOR LINEAR AND ANGULAR DIMENSIONS WITHOUT TOL. ACCORDING UNI-EN 22768-1)	
	M	MEDIA (MEDIUM)	K		
	C	GROSSOLANA (COARSE)	L	GRADO DI PREC. PER TOLLERANZE GEOMETRICHE GENERALI SECONDO UNI-EN 22768-2 (PREC. LEVEL FOR GENERIC GEOMETRIC TOL. ACCORDING UNI-EN 22768-2)	
	V	MOLTO GROSSOLANA (VERY COARSE)	-		
DISEGNATO (DRAWN) : Malaguti			MATERIALE (MATERIAL) :		
CONTROLATO (CHKD) : Malaguti			DESCRIZIONE (DESCRIPTION) :		
 CAMPAGNOLA (RE) - ITALY			Scocca con connettore micro posteriore, 24 fori		
			COD. ATRZ. (TOOL REF.) : --		CODICE (REF.) :
DATA (DATE)		SCALA (SCALE)		 PLA522-24P	
12/01/2022		1:5			

8 7 6 5 4 3 2 1

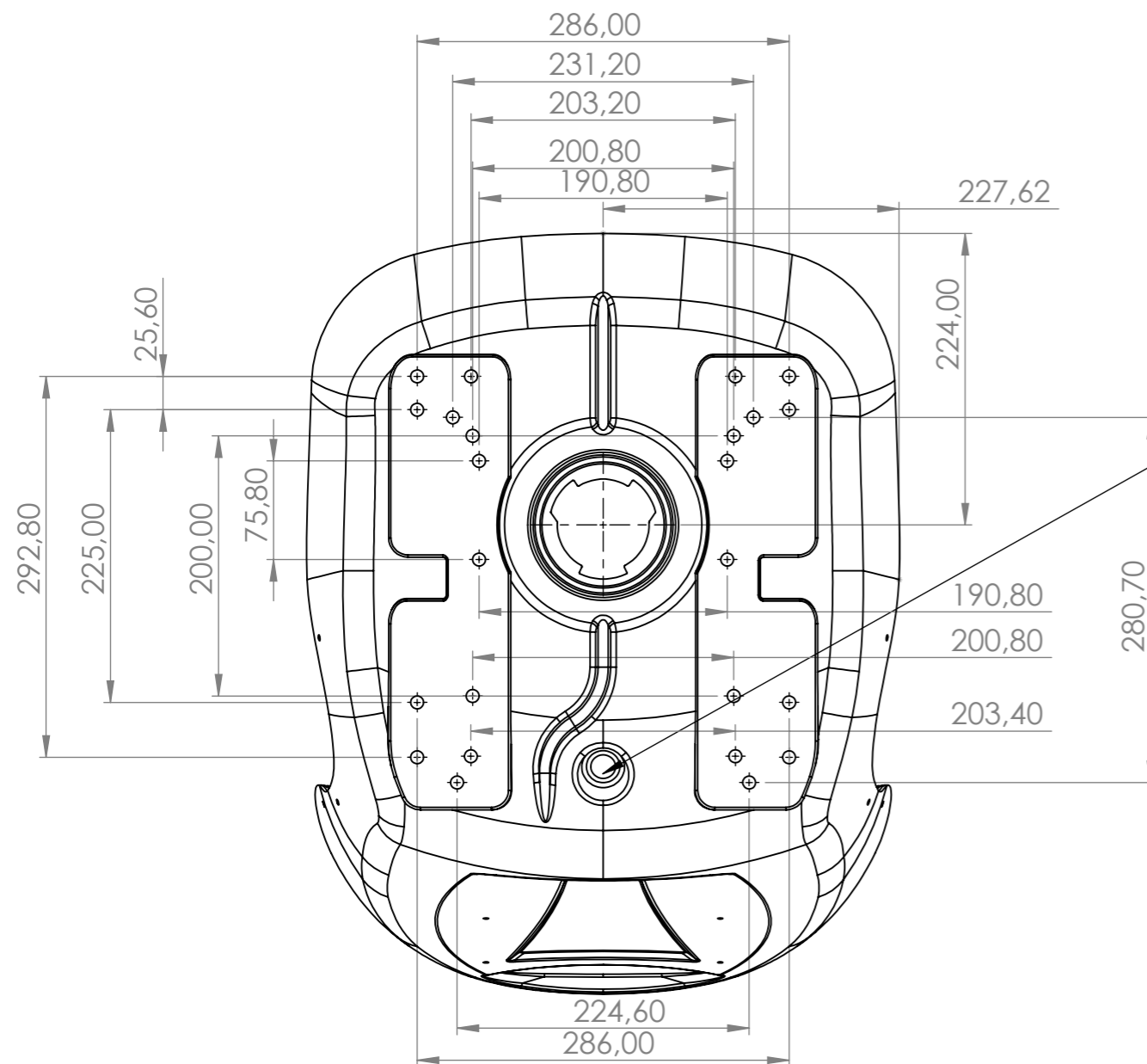
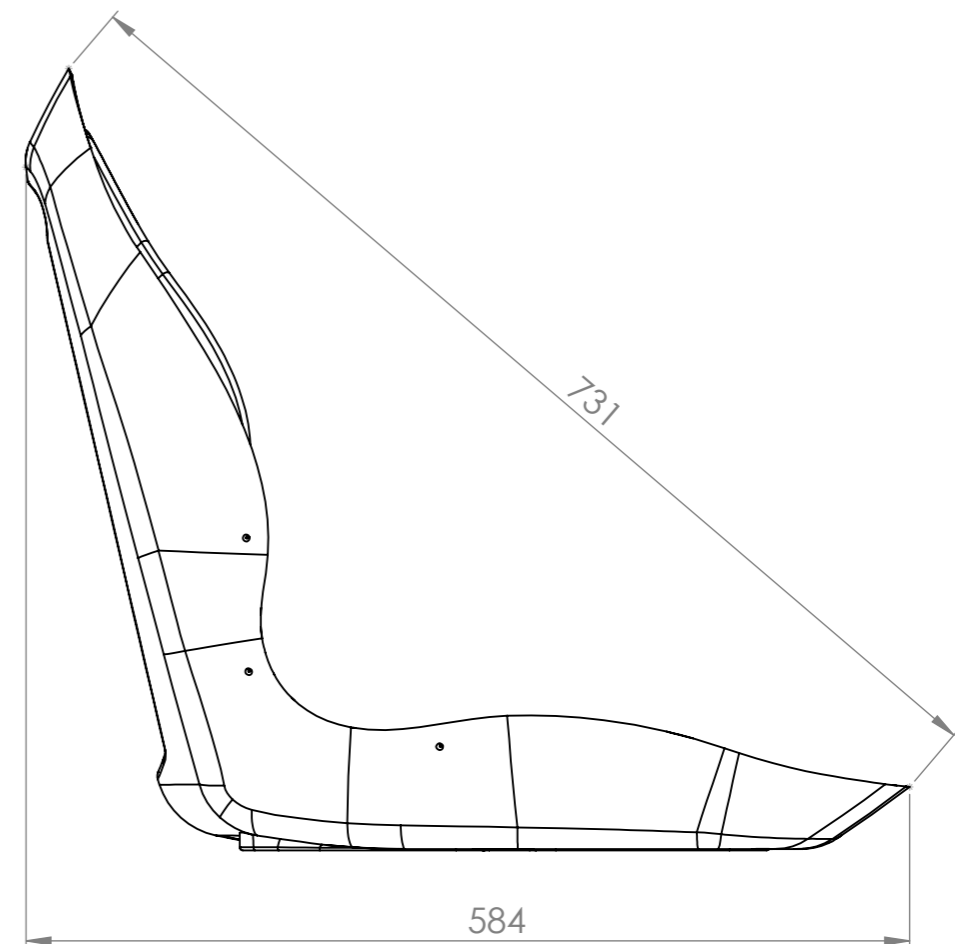
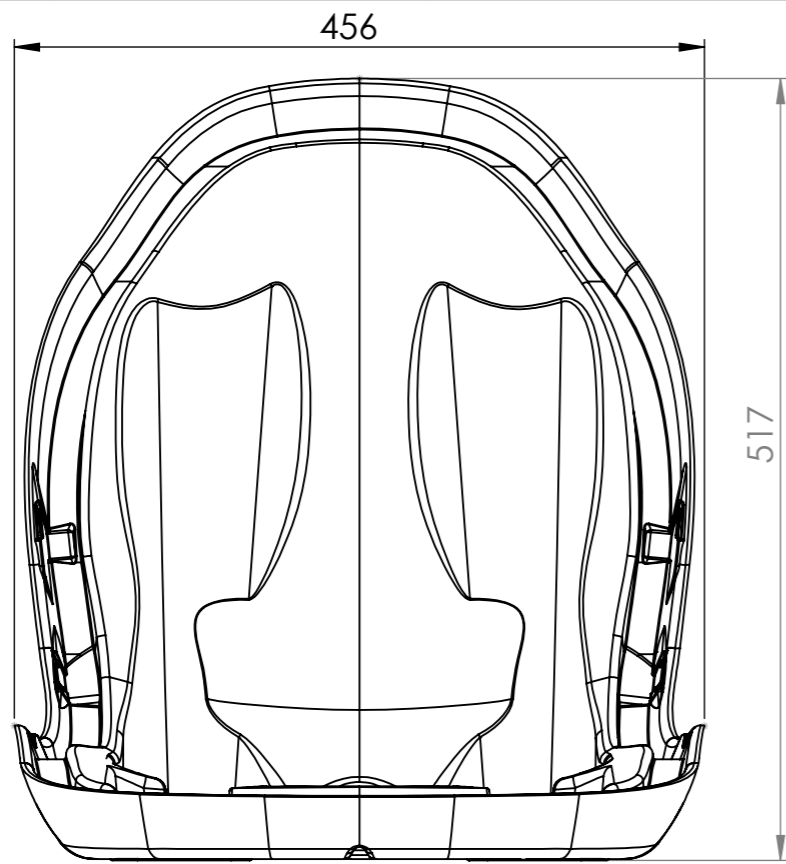

IL FORO DI SCOLO DEVE ESSERE $\varnothing 19$
(NON SBAVARE)

PRE-TRATTAMENTO SUPERF. (1st SURF. TREATMENT)	TRATTAMENTO SUPERF. FINALE (LAST SURF. TREAT.)	QUANTITA' (Q.TY)	RUGOSITA' SUPERF. (SURF. ROUGHN.)
TRATT. TERMICO (HEAT TREATMENT)	PESO GREZZO (RAW W.) (Kg)	PESO FINITO (FINAL W.) (Kg)	FOGLIO (SHEET)
TOLLERANZE GENERALI CARP. (GENERIC CARPENTRY TOLERANCES) :		SMUSSI NON QUOT : 1X45° - RAGGI : R0,5 (CHAMFERS WITHOUT TOL : 1 X 45° - FILLETS : R0,5)	
CESOIA (SHEARING), PIEGA (BENDING) E OSSITAGLIO (OXYCUTTING) : ± 1 mm - SALDATURA (WELDING) : ± 2 mm - PIEGATURA (BENDING) : $\pm 1^\circ$			
DIM LINE ANG (LIN. & ANG. DIM.)	F FINE	H	GRADO DI PREC. PER QUOTE LINEARI E ANGOLARI SENZA TOLLERANZA SECONDO UNI-EN 22768-1 (PREC. LEVEL FOR LINEAR AND ANGULAR DIMENSIONS WITHOUT TOL. ACCORDING UNI-EN 22768-1)
	M MEDIA (MEDIUM)	K	
	C GROSSOLANA (COARSE)	L	GRADO DI PREC. PER TOLLERANZE GEOMETRICHE GENERALI SECONDO UNI-EN 22768-2 (PREC. LEVEL FOR GENERIC GEOMETRIC TOL. ACCORDING UNI-EN 22768-2)
	V MOLTO GROSSOLANA (VERY COARSE)	-	
DISEGNATO (DRAWN) : Malaguti	MATERIALE (MATERIAL) :		A3
CONTROLATO (CHKD) : Trevisi	DESCRIZIONE (DESCRIPTION) :		
		Scocca con connettore micro anteriore	
CAMPAGNOLA (RE) - ITALY		COD. ATRZ. (TOOL REF.) : --	CODICE (REF.) :
	DATA (DATE) : 12/01/2022	SCALA (SCALE) : 1:5	PLA523-24P